

# HYBRIDFMA LIVING SYSTEM OVERVIEW

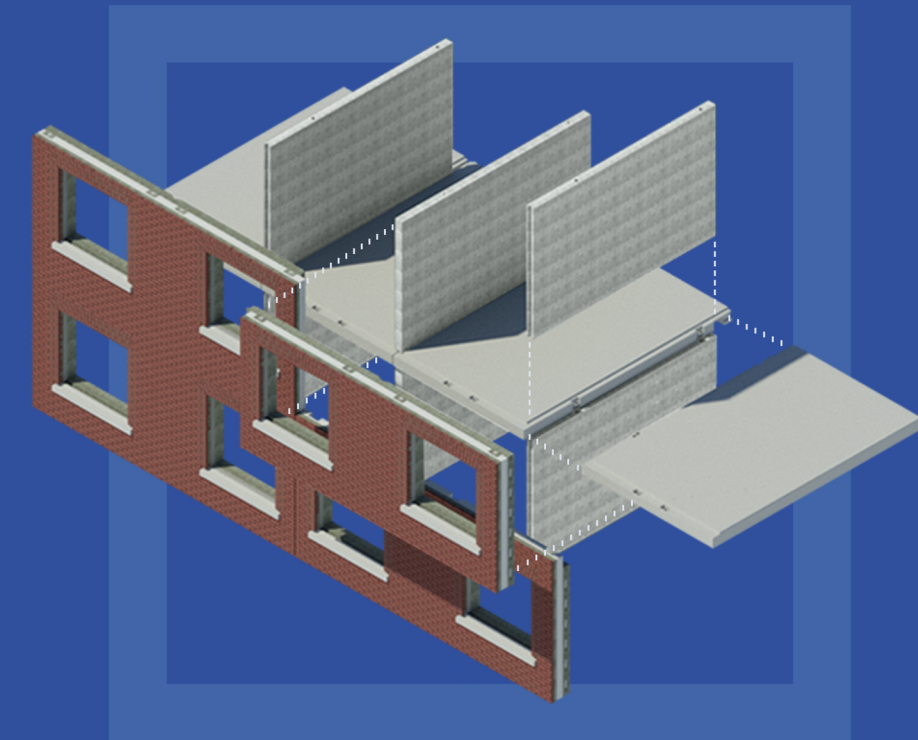

Systemised DfMA delivery of accommodation structures and façades. An Offsite system build 'kit of parts' approach which delivers modern functional living spaces with inherent fire and sound resistance, low operational energy requirements which provides excellent client value.

## System Features

- Integrated façades form part of the structural system
- Concurrent construction facilitates weathertight progression and earlier engagement with follow on trades
- Design flexibility accommodates versatile floor plan arrangements
- Removes need for back-propping
- System integrates M&E components, balconies, utility and bathroom/kitchen pods
- Flexible interchangeability of components through simplified common connection principles
- Structures are configurable for varied use i.e residential, commercial, mixed
- Innovative sandwich panel system with proven, factory-engineered tolerances
- Customisable façade / veneer finishes



## System Benefits

- Reduced carbon through smart design
- Offsite expertise for highest quality and control
- Kit of parts with flexible material interchangeability
- Up 50% reduction in construction programme
- Up to 90% reduction in waste
- Up to 80% reduction in site deliveries
- Up to 80% reduction in on-site personnel



## Digital

Utilising a 3D interactive digital twin model, PCE's digital approach offers many benefits and certainty across all phases of project delivery. Colour-coded visualisation of every unique component with detailed information including engineering calculations, unit drawings, and QA data are delivered via instantaneous feedback and real-time status tracking, which significantly aids early decision-making.

The digital approach, complete with enhanced delivery, quality, and non-conformance reporting connects stakeholders including design, project management, supply chain, installation teams and clients, providing easily accessible, reliable, and accurate information through an intuitive, simplified app and web based digital platform.

